

- Key:**
- Colored Area
  - Hatched Premises
  - Access Easement (Proposed)

0m 30m  
Scale 1:1,500 @ A1

**PARSONS**  
705 BRIDGEMAN  
1000 UNIVERSITY AVENUE  
SANTA MONICA, CA 90406

**TELEBR**  
Civil Engineering  
Bismarck (South) Open Plan  
Revised &  
20th July 2009

AY 2009  
2009/07/20  
**Entec**

100% PARSONS DESIGN (P) AND TELEBR ENGINEERING (P) ARE THE REGISTERED CONSULTANTS FOR THE PROJECT. THE CONSULTANTS' WORK IS THE PROPERTY OF PARSONS DESIGN (P) AND TELEBR ENGINEERING (P). NO PART OF THIS DOCUMENT IS TO BE REPRODUCED OR TRANSMITTED IN ANY FORM OR BY ANY MEANS, ELECTRONIC OR MECHANICAL, WITHOUT THE WRITTEN PERMISSION OF PARSONS DESIGN (P) AND TELEBR ENGINEERING (P).

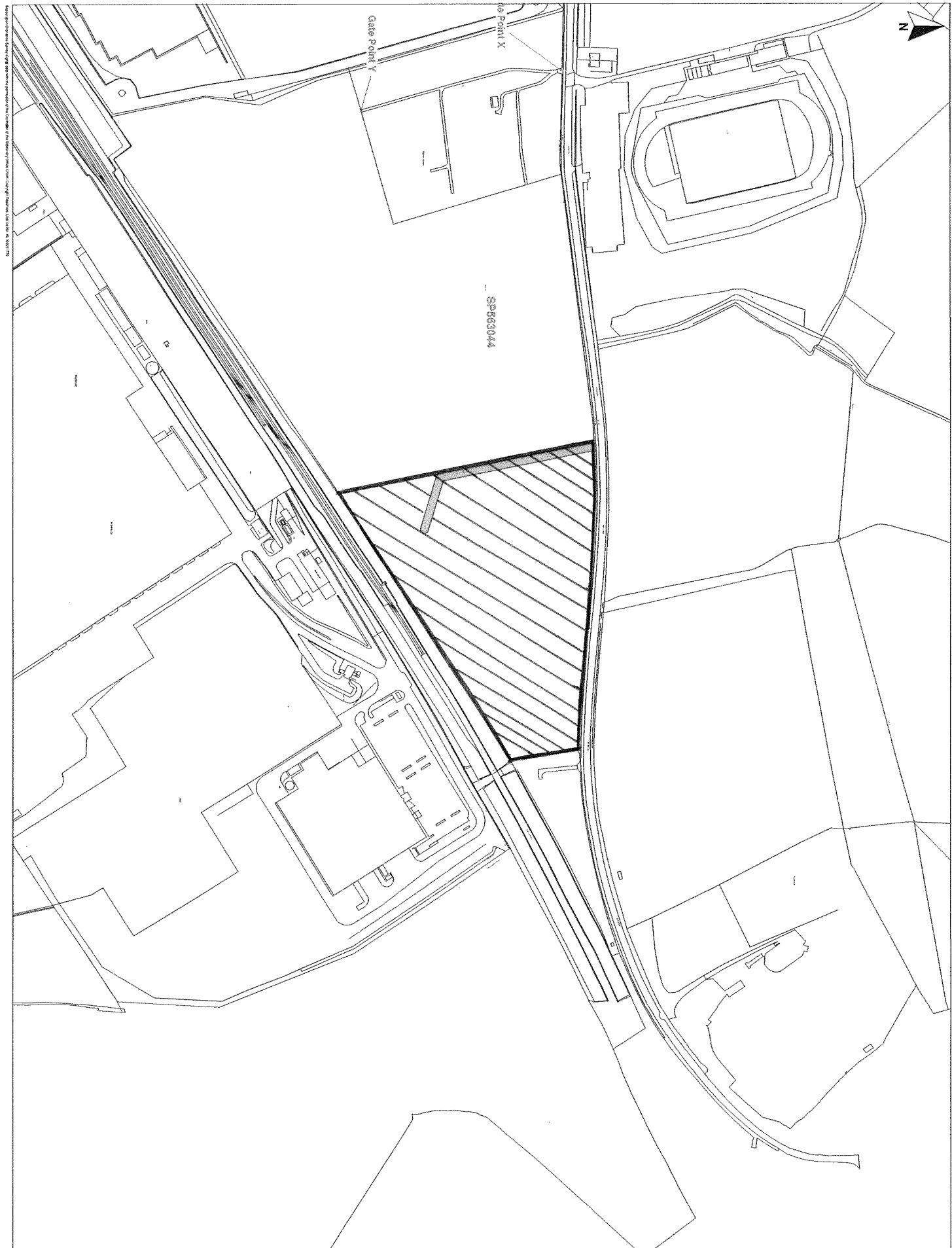

This plan is for information only and does not constitute an offer of any financial product. It is subject to the terms and conditions of the relevant financial product.

**Key:**  
 Open Area  
 Fenced Premises  
 Access Easement (m)

0m 90m  
 Scale 1:1,500 @ A1



CTEB, PFB  
 Outer City Council

Brisbane South Option Plan  
 Revision 7  
 12th February 2010

Author: PFB  
 2008/10/15/16/17/18  
**ENEC**